

**Quality Crafted; Uniquely Styled**  
Since 1974



**Residential Line**



**upwardor**

# Aluminum Doors



**AL-976™** is our Most Popular Aluminum Door, Manufactured since 1976, offers a variety of options where superior strength, maximum visibility and exceptional light transmission are required. Its unique and durable design allows customized configurations for openings up to 24' (7.32m) wide. This modern look can add class to any home.

## Features and Options

- 1-3/4" (44.50mm) thickness • Clear anodized finish standard • Tongue and groove section with weather seal inhibits air filtration.
- Available with various glazing options: single, insulated, tinted, tempered or specialty.

### PANEL CROSS SECTION

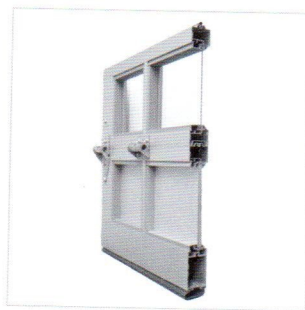
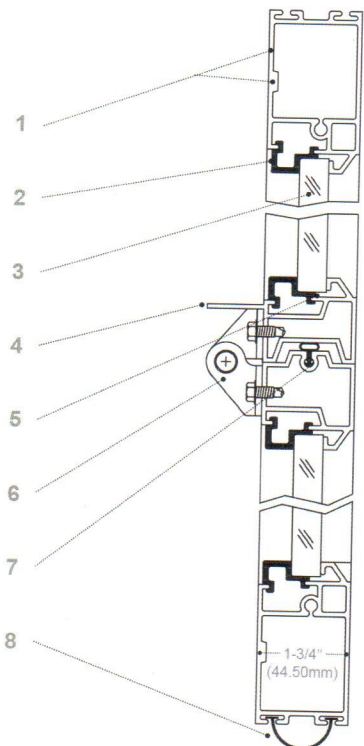

- (1) .070" (1.78mm) typical, .115" (2.92mm) at attachments
- (2) Glazing molding
- (3) Glazing
- (4) Reinforcing strut (optional under 16' [4.88m])
- (5) Soft vinyl glazing bead
- (6) Center hinge
- (7) Weather seal
- (8) Low temp. vinyl astragal

## Customize Your Look!

Choose Your Own  
Custom Colours  
To Match Your Home



**5-year**  
Limited Warranty  
on door finish



**1-year**  
Limited Warranty  
on workmanship  
and materials

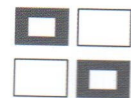

upwardor



# Modern Design

**SOLALITE™** ultra modern design, The Solalite™ door is an exceptional example of innovation and engineering. This door is impact, corrosion and moisture-resistant. The Solalite's sleek and contemporary appearance blends with current architectural trends. A door sure to stand out on your block!

## Features and Options

- Manufactured from 2" thick (50.8mm) corrosion-resistant aluminum extrusions.
- Standard clear anodized finish.
- Polycarbonate, translucent glazing is lightweight, virtually unbreakable and energy efficient.
- Continuous hinge design inhibits water build-up between sections and prevents air infiltration, which maximizes thermal resistance.

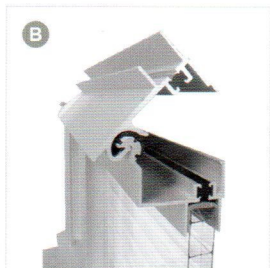
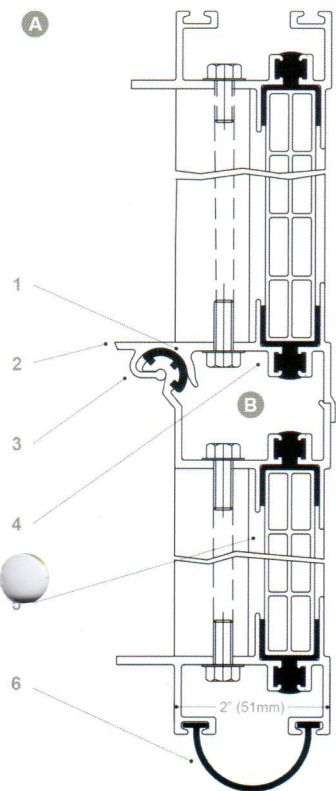

- (1) PVC bushing
- (2) Built-in integral strut
- (3) Continuous hinge extrusion
- (4) Thermally broken frame (optional)
- (5) 5/8" (16mm) five wall polycarbonate clear, light bronze or dark bronze
- (6) Low temperature vinyl bottom astragal

## Customize Your Look!

Choose Your Own Custom Colours To Match Your Home



**5-year**  
Limited Warranty  
on door finish



**1-year**  
Limited Warranty  
on workmanship  
and materials



upwardor



LIFETIME



Sheridan XL White Shown

The Kanata Collection™ combines style and durability with environmental friendliness. Polyurethane insulation is foamed in place, which ensures a consistent density and significant panel strength. With a 1-3/4" (44.50mm) thickness, R-value of 16.3, enhanced tongue and groove joint and a true thermal break, the Kanata Collection™ is an excellent choice for those who are looking for a high-quality, energy efficient residential garage door.

SIDE VIEW ILLUSTRATION

1-3/4" (44.50mm)

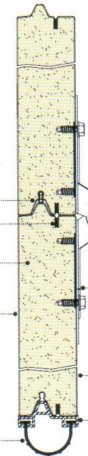

- (1) Low temperature vinyl bulb weather seal
- (2) Thermal break foam tape
- (3) Foamed-in-place polyurethane ozone friendly zero (ODP)
- (4) 26ga exterior prefinished steel skin
- (5) Low temperature vinyl bottom astragal
- (6) Full hinge application
- (7) Hinge/strut reinforcement steel strips
- (8) Embossed back sheet
- (9) PVC bottom retainer

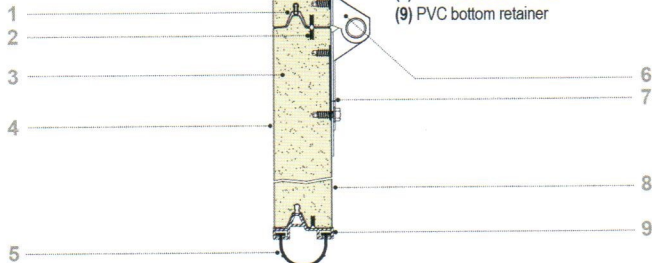

Actual door colour will vary from colour renditions  
\*Not available in 18" sections

Upgrade To Custom Colours  
To Match Your Home



PRODUCT SELECTION GUIDE & SPECIFICATIONS

EXTERIOR/INTERIOR STEEL BACKSHEET	26-GAUGE, PEBBLE EMBOSSED
HORIZONTAL REINFORCEMENT STRIP	25-GAUGE (2 PER PANEL)
END STILES - WHITE GALVANIZED	20-GAUGE
MAXIMUM STANDARD WIDTH	18'0" (5.49m)
MAXIMUM STANDARD HEIGHT	3" (76mm) INCREMENTS
SECTION HEIGHT	18", 21", & 24" (457, 533 & 610mm)
WARRANTY	LIMITED LIFETIME SEE WARRANTY SHEET
STANDARD RADIUS	15" (12" AVAILABLE UPON REQUEST)





Sheridan XL Bronze Shown\*

## WINDOW INSERTS

### STOCKTON



STANDARD



TEN SQUARE XL • STOCKTON



ARCHED XL • STOCKTON

### CASCADE



STANDARD

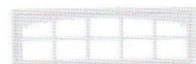

CASCADE XL

### STOCKBRIDGE



STRAIGHT



STRAIGHT XL • STOCKBRIDGE



ARCHED XL • STOCKBRIDGE

### PRAIRIE



STANDARD

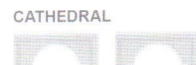

CATHEDRAL

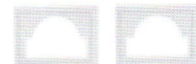

STANDARD

### SUNBURST



FOUR PIECE

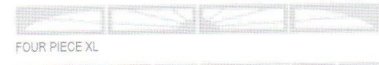

FOUR PIECE XL



EIGHT PIECE

### WAGON WHEEL



TWO PIECE



TWO PIECE XL

### WATERTON



STANDARD



WATERTON XL

## PANEL CHOICES

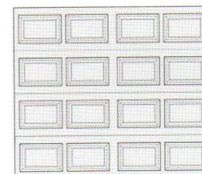

SHERIDAN  
Raised Panel

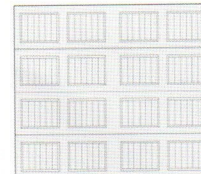

BRONTE CREEK  
Carriage House



TRAFALGAR  
Ribbed Panel

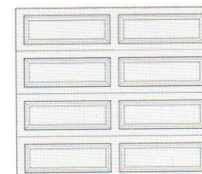

SHERIDAN XL  
Raised Panel

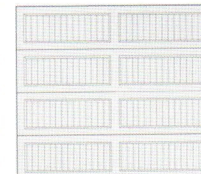

BRONTE CREEK XL  
Carriage House

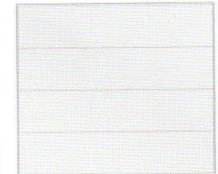

FLUSH



Trafalgar Black Shown



LIFETIME



Denison White Shown\*

The Craft Series™ represents the ultimate in style, durability and environmental friendliness. Our new three section, taller panel design offers a truly distinct look while maintaining the quality and performance you would expect from a premium door, ideal for the home owner who is looking for more than just curb appeal.

PANEL CHOICES

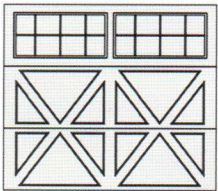

MUSKOKA

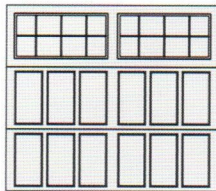

DENISON

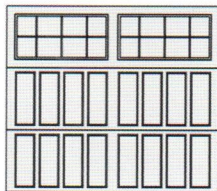

GRANVILLE

COLOUR CHOICES



WHITE



SANDTONE



WALNUT  
(28" ONLY)

Actual door colour will vary from colour renditions.

Upgrade To Custom Colours  
To Match Your Home



PRODUCT SELECTION GUIDE & SPECIFICATIONS

THICKNESS/PRODUCT TYPE	1-3/4" (44.50mm)
EXTERIOR/INTERIOR STEEL BACKSHEET	26-GAUGE, PEBBLE EMBOSSED
INSULATION TYPE/ FOAM PROCESS	ZERO ODP POLYURETHANE/ CONTINUOUS
R-VALUE/U-VALUE	16.3/0.06
SECTION JOINT	TONGUE & GROOVE
HORIZONTAL REINFORCEMENT STRIP	25-GAUGE (2 PER PANEL)
END STILES - WHITE GALVANIZED	20-GAUGE
AVAILABLE WIDTHS	8', 9', 12', & 16'
MAXIMUM HEIGHT	8' & 7'
SECTION HEIGHT	28" & 32" (711 & 813mm)
WARRANTY	LIMITED LIFETIME SEE WARRANTY SHEET
HARDWARE WARRANTY	1-YEAR
STANDARD RADIUS	20"
CLEARANCE AT HEADER	23" MIN



Granville Walnut Shown\*



Muskoka White Shown\*



### SIDE VIEW ILLUSTRATION

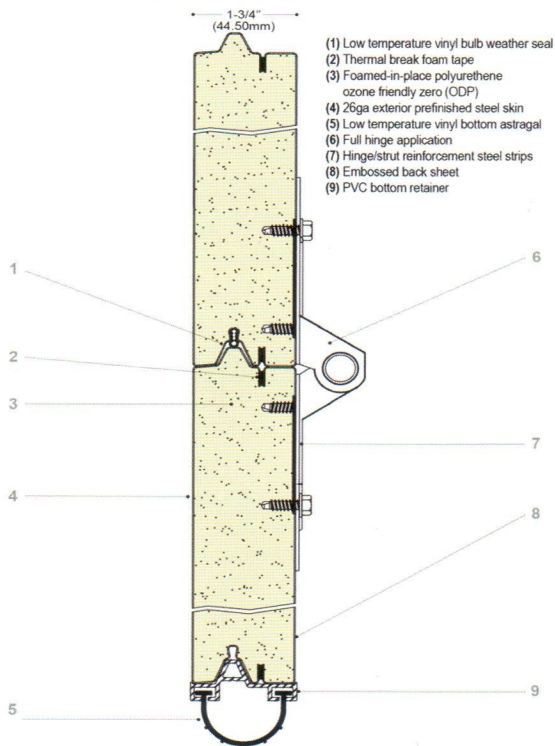

### PRODUCT SELECTION GUIDE & SPECIFICATIONS

THICKNESS/PRODUCT TYPE	1-3/4" (44.50mm)
EXTERIOR/INTERIOR STEEL BACKSHEET	26-GAUGE, PEBBLE EMBOSSED
INSULATION TYPE/FOAM PROCESS	ZERO ODP POLYURETHANE/CONTINUOUS
R-VALUE/U-VALUE	16.3/0.06
SECTION JOINT	TONGUE & GROOVE
HORIZONTAL REINFORCEMENT STRIP	25-GAUGE (2 PER PANEL)
END STILES - WHITE GALVANIZED	20-GAUGE
AVAILABLE WIDTHS	8', 9', 12', & 16'
MAXIMUM HEIGHT	8' & 7'
SECTION HEIGHT	28" & 32" (711 & 813mm)
WARRANTY	LIMITED LIFETIME SEE WARRANTY SHEET
HARDWARE WARRANTY	1-YEAR
STANDARD RADIUS	20"
CLEARANCE AT HEADER	23" MIN

### WINDOW INSERTS

#### STOCKTON



EIGHT SQUARE



ARCHED

#### STOCKBRIDGE



STRAIGHT



ARCHED

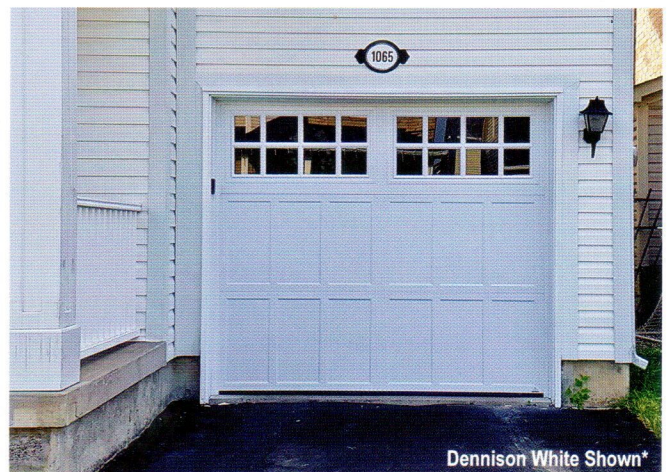

Dennison White Shown\*